

STROOD AVENUE - HENDERSON HIGHWAY TO ROTHESAY STREET  
STUART AVENUE - PENTLAND STREET TO HENDERSON HIGHWAY

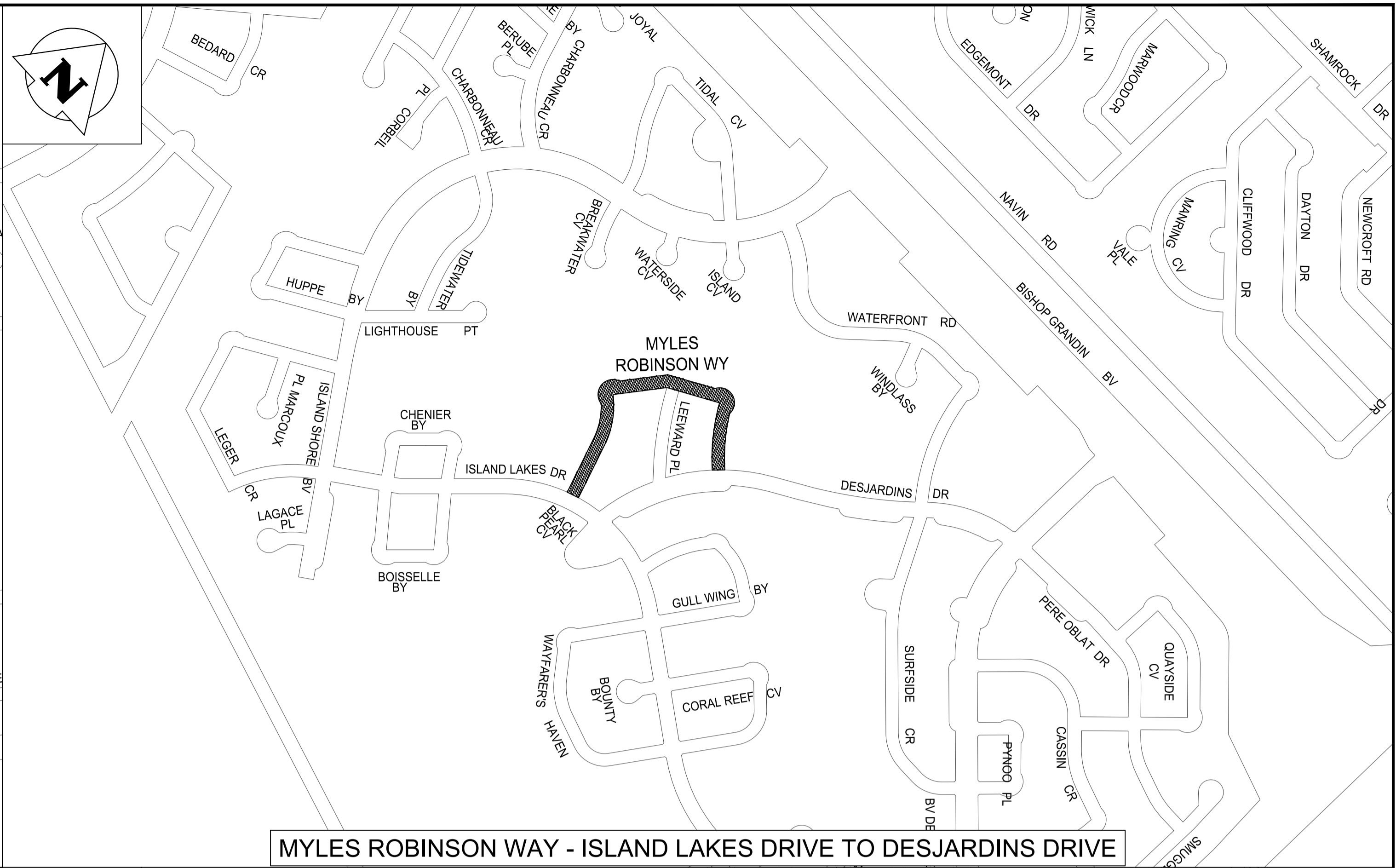

MYLES ROBINSON WAY - ISLAND LAKES DRIVE TO DESJARDINS DRIVE  
FURNESS BAY - BURLAND AVENUE TO HEALY CRESCENT

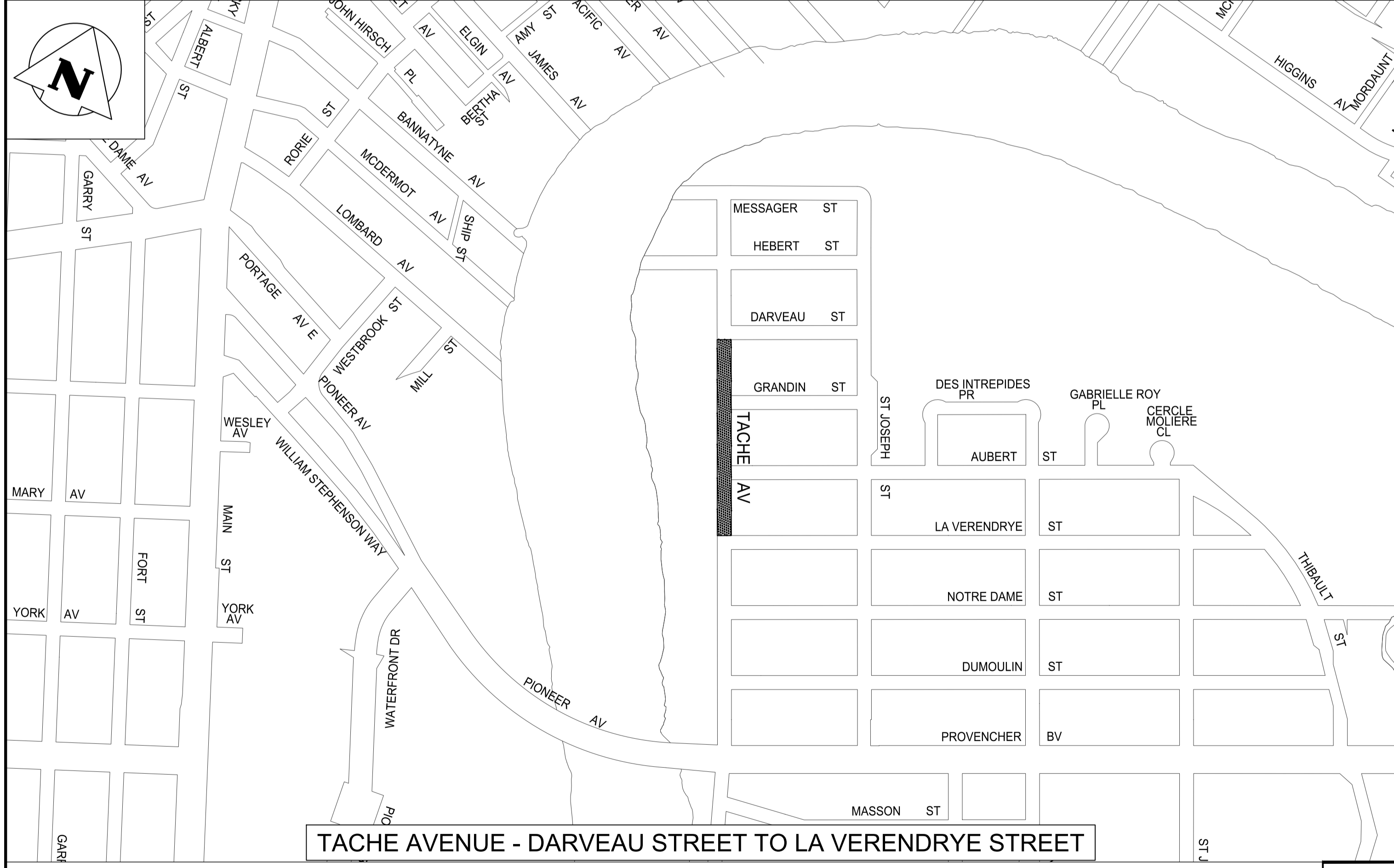

TACHE AVENUE - DARVEAU STREET TO LA VERENDRYE STREET

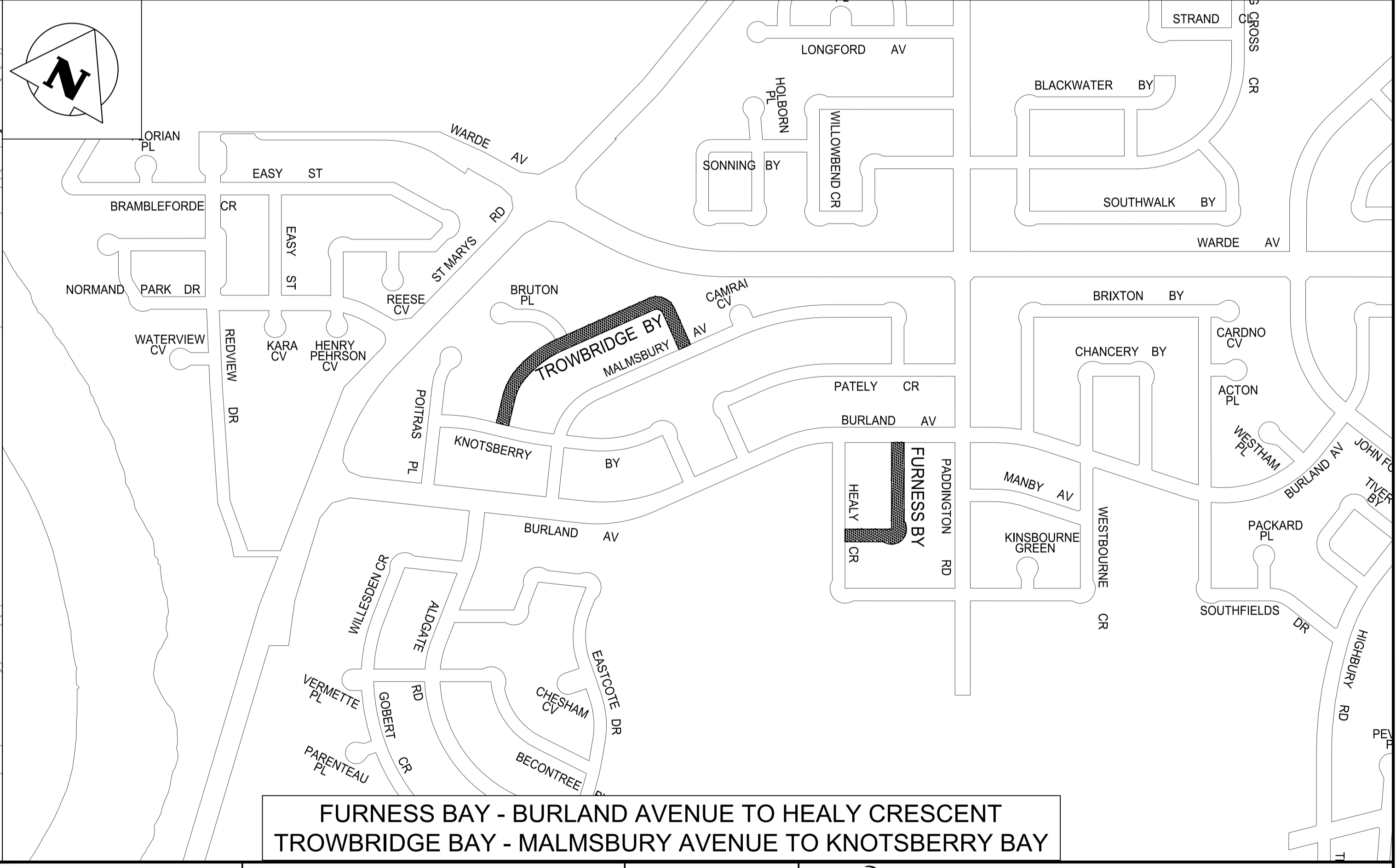

TROWBRIDGE BAY - MALMSBURY AVENUE TO KNOTSBERRY BAY

P:\Projects\2020\20-01-07-006\Drawg\Mun PLOT 1:1 (A-1)



- LEGEND:**
- AREA OF NEW OVERLAY
  - BUS ROUTE
  - SCHOOL LOCATION

		DESIGNED BY: MAT	CHECKED BY: CR
		DRAWN BY: IT	APPROVED BY:
HOR. SCALE: 1:5000		RELEASED FOR CONSTRUCTION:	
ISSUED FOR TENDER: 0	DATE: 20/07/06	DATE:	DATE:
NO. REVISIONS:	DATE:	BY:	DATE:

**THE CITY OF WINNIPEG**  
 PUBLIC WORKS DEPARTMENT  
 ENGINEERING DIVISION

PROJECT TITLE  
**2020 THIN BITUMINOUS OVERLAY (TBO) PROGRAM - CONTRACT 2**  
 STROOD AVENUE, STUART AVENUE, MYLES ROBINSON WAY, TACHE AVENUE, FURNESS BAY, TROWBRIDGE BAY

SHEET 01 OF 03  
 COMPUTER FILE NAME: 20-0107-006 TBO\_CONTRACT 2.DWG  
 CITY DRAWING NUMBER: --

CONSULTANT DRAWING NO. **C01**